

# MESUCO 131X rapid

## Con INDAmatic integrado

- > INDAmatic integrado en el brazo de la bisagra para un cierre suave y silencioso.
- > El sistema de amortiguación es completamente invisible.
- > Programa: bisagra estándar a 110° con diferentes acodados y bisagra de ángulo abierto a 165°.
- > La MESUCO 131X montaje clip está concebida para puertas de 14 a 26 mm de espesor.
- > Cierre uniforme y amortiguado garantizado, sin necesidad de montaje extra.
- > Completa la gama de bisagras con amortiguación de Indaux.

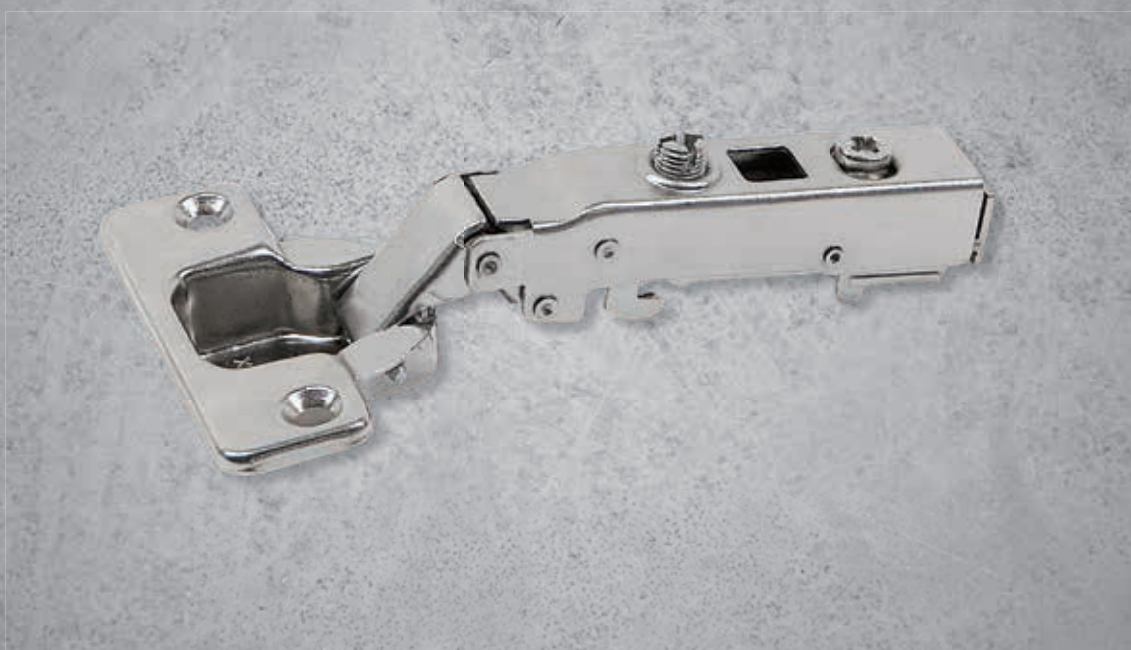

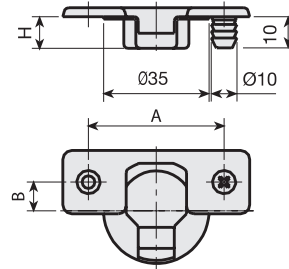
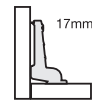
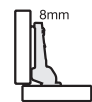

INDAmatic

1 FAMILIA DE BISAGRAS



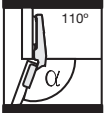
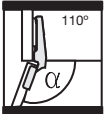
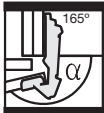
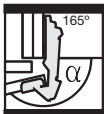
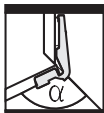



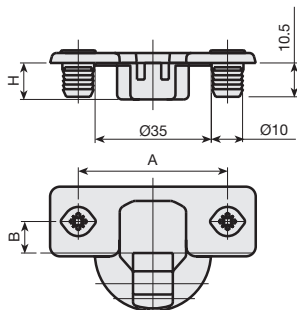





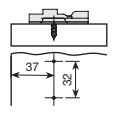

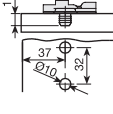

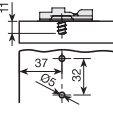
NIQUEL

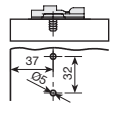
	NIQUEL						
	A: 48, B: 6		A: 52, B: 5,5		A: 45, B: 9,5		
	M/tirafondos	Montaje Directo	M/tirafondos	Montaje Directo	M/tirafondos	Montaje Directo Ø8	
 <p><math>\alpha = 0^\circ \div 110^\circ</math> H = 11.3</p>	0mm.	319.010.064	319.020.063	319.210.065	319.220.064	319.110.061	397.400.065
	8mm.	319.011.066	319.021.065	319.211.060	319.221.066	319.111.063	397.401.060
	17mm.	319.012.061	319.022.060	319.212.062	319.222.061	319.112.065	319.122.064
 <p>Sin amortiguación <math>\alpha = 0^\circ \div 110^\circ</math> H = 11.3</p>	0mm.	319.710.064	319.720.063	319.770.065	319.780.064	319.740.061	319.750.060
	8mm.	319.711.066	319.721.065	319.771.060	319.781.066	319.741.063	319.751.062
	17mm.	319.712.062	319.722.060	319.772.062	319.782.061	319.742.065	319.752.064
 <p><math>\alpha = 0^\circ \div 165^\circ</math> H = 11.3</p>	0mm.	319.040.061	319.050.060	319.240.062	319.250.061	319.140.065	319.150.064
 <p>Sin amortiguación <math>\alpha = 0^\circ \div 165^\circ</math> H = 11.3</p>	0mm.						
 <p><math>\alpha = 30^\circ \div 140^\circ</math> <math>\alpha = 45^\circ \div 155^\circ</math> H = 11.3</p>	0mm.	319.070.065	319.071.060	319.270.066	319.271.061	319.170.062	319.171.064
	0mm.	319.080.064	319.081.066	319.280.065	319.281.060	319.180.061	319.181.063
 <p><math>\alpha = 90^\circ \div 200^\circ</math> H = 11.3</p>	0mm.	319.090.063	319.091.065	319.290.064	319.291.066	319.190.060	319.191.062

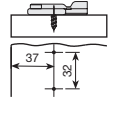

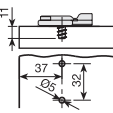
NIQUEL		
A: 48, B: 6	A: 52, B: 5,5	A: 45, B: 9,5
Expand	Expand	Expand
319.030.062	319.230.063	319.130.066
319.031.064	319.231.065	319.131.061
319.032.066	319.232.060	319.132.063
319.730.062	319.790.063	319.760.066
319.731.064	319.791.065	319.761.061
319.732.066	319.792.060	319.762.063
319.060.066	319.260.060	319.160.063
	319.862.060	

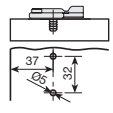
**2** PLACAS BASE

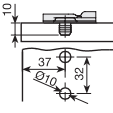
CALCES en mm.				0	2	4
		Base montaje tirafondos Regulación vertical $\pm 2$ mm	Acero Niquel	353.010.066	353.012.063	353.014.060
		Base montaje directo Regulación vertical $\pm 2$ mm	Acero Niquel	353.090.065	353.092.062	353.024.066
		Base euro-screw premon-tado Regulación vertical $\pm 2$ mm	Acero Niquel	353.030.064	353.032.061	353.034.065
		Base con centrador Regulación vertical $\pm 2$ mm	Acero Niquel	353.040.063	353.042.060	353.044.064
		Base montaje tirafondos Regulación vertical $\pm 1,9$ mm	Acero Niquel	353.050.062	353.052.066	353.054.063
		Base montaje tirafondos Regulación vertical $\pm 1,9$ mm	Acero Niquel	353.100.064		
		Base euro-screw premon-tado Regulación vertical $\pm 1,9$ mm		353.060.061	353.062.065	353.064.062
		Base con centrador Regulación vertical $\pm 1,9$ mm	Acero Niquel		353.072.064	353.074.061
		Base montaje directo Regulación vertical $\pm 1,9$ mm	Acero Niquel	353.080.066	353.082.063	

**3 DATOS TÉCNICOS**

**MESUCO 131X RAPID Apertura 110°**

Recta

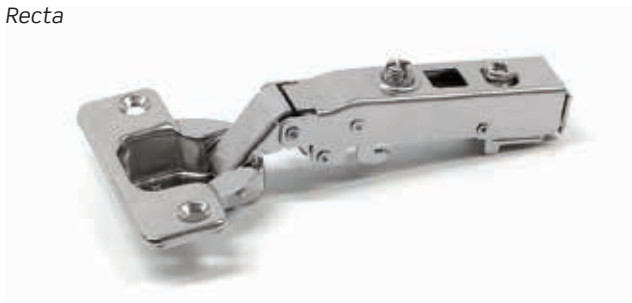

Cálculo de Calce  
 $C = B + K - D$   
 $K = \text{Constante} = 12,5\text{mm}$

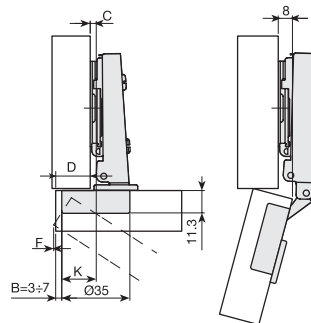

Acodada

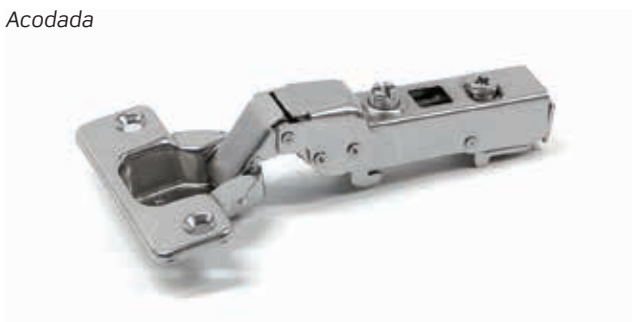

Cálculo de Calce  
 $C = B + K - D$   
 $K = \text{Constante} = 4,5\text{mm}$

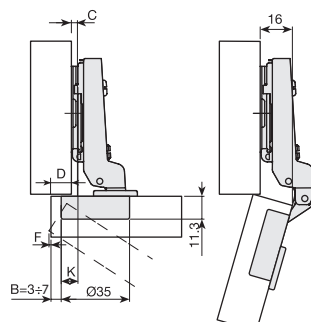

Superacodada\*



Cálculo de Calce  
 $C = B + K + D$   
 $K = \text{Constante} = -4,5\text{mm}$

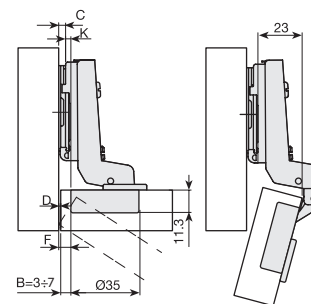

\* Se debe retroceder la posición de fijación de la placa una distancia igual al espesor de la puerta más 1mm

Desplazamiento lateral de la puerta (F).

mm	Espesor de la puerta								
B	16	17	18	19	20	21	22	23	24
3	0,7	1	1,3	1,6	2	2,5	3,1	3,8	4,6
4	0,7	1	1,3	1,6	2	2,4	3	3,6	4,2
5	0,7	1	1,2	1,5	1,9	2,3	2,8	3,3	3,9
6	0,7	1	1,2	1,5	1,8	2,2	2,7	3,1	3,7
7	0,7	0,9	1,1	1,4	1,7	2,1	2,6	3	3,5

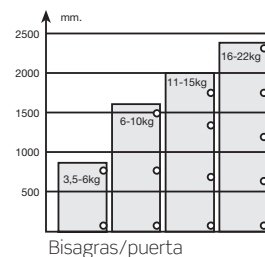
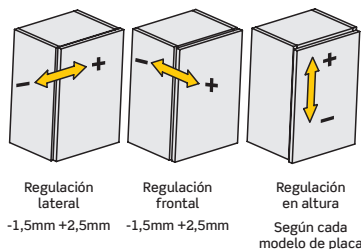

■ MESUCO 131 X Apertura 30° ÷ 140°

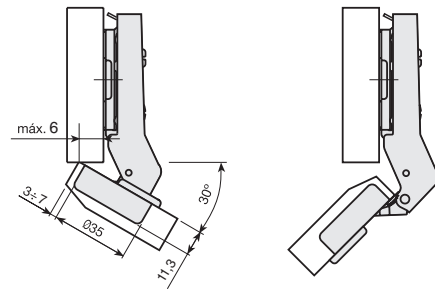

■ MESUCO 131 X Apertura 45° ÷ 155°

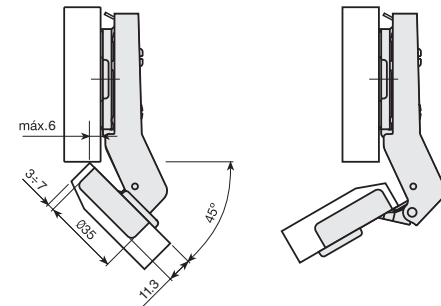

■ MESUCO 131 X Apertura 90° ÷ 200°



Cálculo de la posición de la placa  
 $X = 24 - B - F$   
 $K = \text{Constante} = 0\text{mm}$

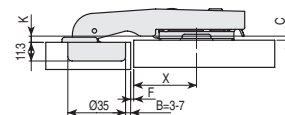

Desplazamiento lateral de la puerta (F).

Espesor de la puerta

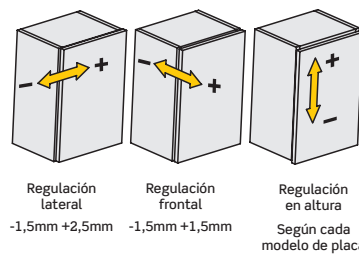

mm.	3,5-6kg	7-11kg	12-16kg	18-24kg
2500	d	d	d	d
2000	d	d	d	d
1500	d	d	d	d
1000	d	d	d	d
500	d	d	d	d

Bisagras/puerta

■ **MESUCO 131X RAPID Apertura 165°**

Recta



Cálculo de Calce  
 $C = B + K - D$   
 $K = \text{Constante} = 10,5\text{mm}$

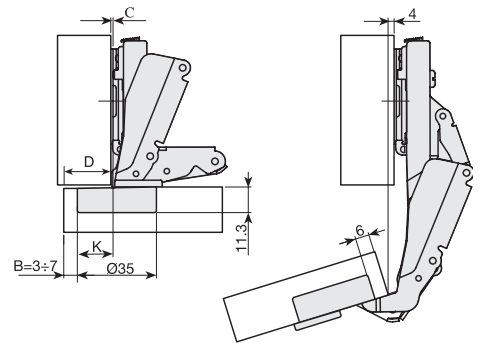

**4 EMBELLECEDORES**

Embellecedor de bisagra.

Acero	Niquelado	302.131.060
-------	-----------	-------------

El embellecedor puede ser personalizado mediante estampación o serigrafía.



Embellecedor de puerta

		A:48 - A:45	A:52
Acero	Niquelado	302.131.048	302.131.052

