

# COMBI

## Cajón compacto

Cajón inyectado para módulos hasta 600 mm. Tres longitudes para mayor capacidad. Ahora con la opción de incorporar el sistema de cierre suave **INDAmatic**.



**INDAmatic**  
CIERRE PROGRESIVO

# 1 CAJÓN COMBI-275

## Cajones

### Cajón COMBI-275.

| Módulo | Blanco RAL 9001 |  |
|--------|-----------------|---|
| 175    | 680.417.006     | 25  |
| 200    | 680.420.005     |   |
| 250    | 680.425.001     |   |
| 300    | 680.430.004     |   |
| 350    | 680.435.000     |   |
| 400    | 680.440.003     |   |



## Correderas

### Corredera.

| Longitud | Pérdida salida PS | Blanco RAL 9001 |  |
|----------|-------------------|-----------------|---|
| 275      | 50                | 788.116.000     | 100   |

Cada referencia se compone de un juego.

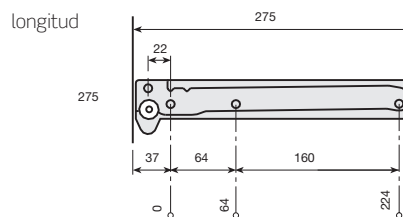
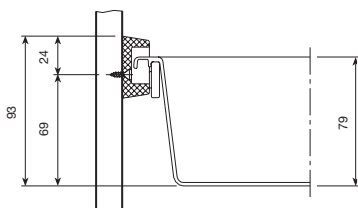

## Enganche del frente

### Enganche frontal regulable.

| Blanco RAL 9001 |  |
|-----------------|---|
| 685.000.002     | 100   |

Cada referencia se compone de un juego completo de enganches.

### Enganche frontal regulable con aletas a 15mm.

| Blanco RAL 9001 |  |
|-----------------|---|
| 685.200.003     | 100   |

Cada referencia se compone de un juego completo de enganches.

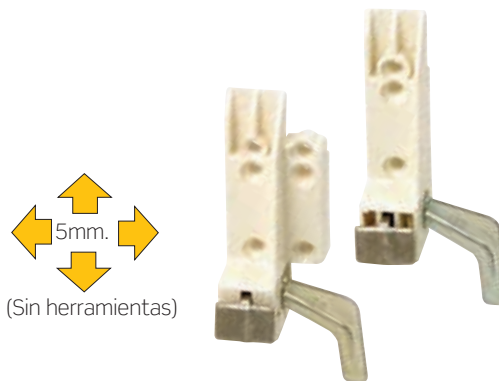

| Módulo | F   |
|--------|-----|
| 175    | 37  |
| 200    | 62  |
| 250    | 112 |
| 300    | 162 |
| 350    | 212 |
| 400    | 262 |

**NOTA**  
Para la colocación del enganche con aletas hay que sumarle 30mm. a la cota F.

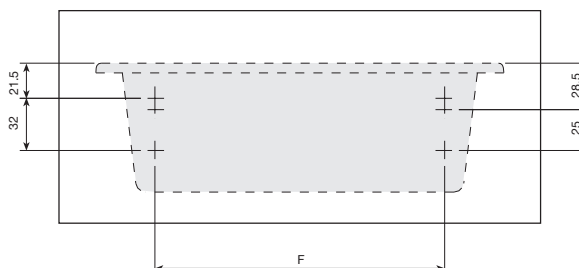

## 2 CAJÓN COMBI-440

### Cajones

#### Cajón COMBI-440.

| Módulo | Blanco RAL 9001 | Beige RAL 1015 |  |
|--------|-----------------|----------------|---|
| 300    | 680.330.000     | 680.330.464    | 25  |
| 350    | 680.335.003     | 680.335.460    |   |
| 400    | 680.340.006     | 680.340.463    |   |
| 450    | 680.345.002     | 680.345.466    |   |
| 500    | 680.350.005     | 680.350.462    |   |
| 600    | 680.360.004     | 680.360.461    |   |



#### Cajón COMBI-440 KIT-4.

| Módulo | Blanco RAL 9001 | Beige RAL 1015 |  |
|--------|-----------------|----------------|---|
| 300    | 681.430.002     | 681.430.466    | 1   |
| 350    | 681.435.005     | 681.435.462    |   |
| 400    | 681.440.001     | 681.440.465    |   |
| 450    | 681.445.004     | 681.445.461    |   |
| 500    | 681.450.000     | 681.450.464    |   |
| 600    | 681.460.006     | 681.460.463    |   |

Cada referencia se compone de 4 cajones con sus correspondientes correderas, enganches, y tirafondos.

#### Cajón COMBI-440 KIT-5.

| Módulo | Blanco RAL 9001 | Beige RAL 1015 |  |
|--------|-----------------|----------------|---|
| 300    | 681.530.006     | 681.530.463    | 1   |
| 350    | 681.535.002     | 681.535.466    |   |
| 400    | 681.540.005     | 681.540.462    |   |
| 450    | 681.545.001     | 681.545.465    |   |
| 500    | 681.550.004     | 681.550.461    |   |
| 600    | 681.560.003     | 681.560.460    |   |

Cada referencia se compone de 5 cajones con sus correspondientes correderas, enganches, y tirafondos.

| Módulo | Anchura | Largo | Alto |
|--------|---------|-------|------|
| 300    | 250     | 435   | 79   |
| 350    | 300     |       |      |
| 400    | 350     |       |      |
| 450    | 400     |       |      |
| 500    | 450     |       |      |
| 600    | 550     |       |      |

### Correderas

#### Correderas para costado de 15÷16mm.

| Pérdida de salida PS | Blanco RAL 9001 | Beige RAL 1015 |  |
|----------------------|-----------------|----------------|---|
| 90                   | 789.216.002     | 789.216.466    | 100   |

Cada referencia se compone de un juego.



#### Correderas para costado de 18÷19mm.

| Pérdida de salida PS | Blanco RAL 9001 | Beige RAL 1015 |  |
|----------------------|-----------------|----------------|---|
| 90                   | 789.219.001     | 789.219.465    | 100   |

Cada referencia se compone de un juego.

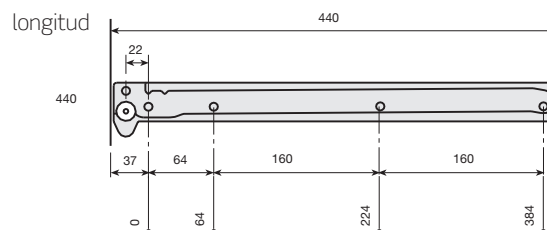
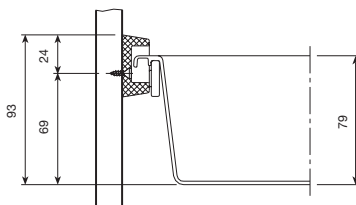

■ Enganche del frente

Enganche frontal regulable.

| Blanco RAL 9001 | Beige RAL 1015 |  |
|-----------------|----------------|---|
| 685.000.002     | 685.000.466    | 100   |

Cada referencia se compone de un juego completo de enganches.

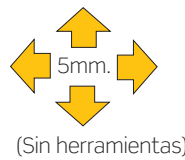

Enganche frontal regulable con aletas a 15mm.

| Blanco RAL 9001 | Beige RAL 1015 |  |
|-----------------|----------------|---|
| 685.200.003     | 685.200.460    | 100   |

Cada referencia se compone de un juego completo de enganches.

| Módulo | F   |
|--------|-----|
| 300    | 162 |
| 350    | 212 |
| 400    | 262 |
| 450    | 312 |
| 500    | 362 |
| 600    | 462 |

**NOTA**

Para la colocación del enganche con aletas hay que sumarle 30mm. a la cota F.

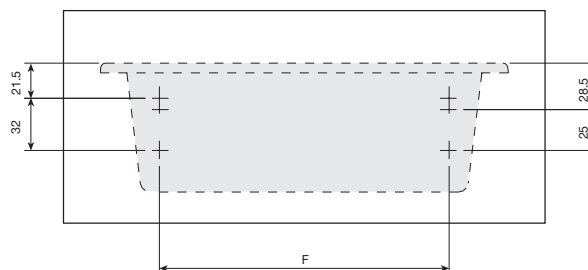

■ Accesorios cajón cacerolero

Cerco para cajón COMBI-440.

| Módulo | L   | Cromado     |  |
|--------|-----|-------------|---|
| 300    | 230 | 745.230.124 | 20  |
| 350    | 280 | 745.235.120 |   |
| 400    | 330 | 745.240.123 |   |
| 450    | 380 | 745.245.126 |   |
| 500    | 430 | 745.250.122 |   |
| 600    | 530 | 745.260.121 |   |

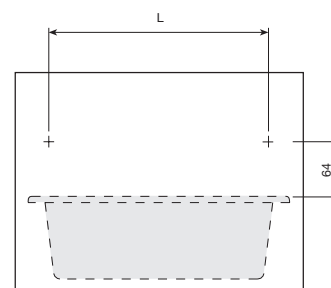
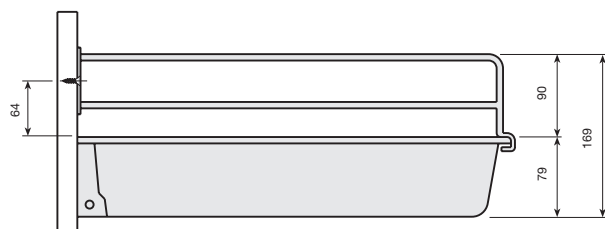
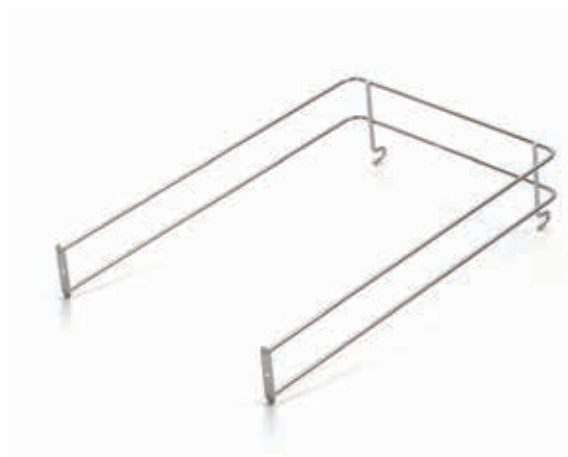

■ **Cuberteros**

Cuberteros diseñados para modulaciones del cajón **COMBI**. Este cubertero se presenta en dos versiones: ajustado en cuatro lados para todos los módulos, y con faldón lateral para cajones a partir de módulo 350 y 450, dando una mayor versatilidad, ya que sirve para varios modelos.

**Cuberteros COMBI-440.**

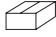
| Módulo | Blanco      | Beige RAL 1015 | Medidas |       |      |  |
|--------|-------------|----------------|---------|-------|------|---|
|        |             |                | Largo   | Ancho | Alto |   |
| 300    | 687.130.006 | 687.130.463    | 391     | 206   | 45   | 25  |
| 350    | 689.035.001 | 689.035.465    | 391     | 256   | 45   | 20  |
| 400    | 687.140.005 | 687.140.462    | 391     | 306   | 45   | 25  |
| 450    | 689.045.000 | 689.045.464    | 391     | 356   | 45   | 20  |
| 500    | 689.050.003 | 689.050.460    | 391     | 406   | 45   | 20  |
| 600    | 689.060.002 | 689.060.466    | 391     | 506   | 45   | 20  |

Estos cuberteros no llevan faldón, y se ajustan en los cuatro lados del cajón de todos los módulos.

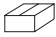

**Cubertero COMBI-440 con aleta.**

| Modelo | Blanco      | Beige RAL 1015 |  |
|--------|-------------|----------------|---|
|        |             |                |   |
| 350    | 687.135.002 | 687.135.466    | 25  |
| 450    | 687.145.001 | 687.145.465    |   |

Estos cuberteros llevan faldón, y sirven para cajones a partir del módulo 350 y 450 respectivamente.



### 3 CAJÓN COMBI-480

#### ■ Cajones

##### Cajón COMBI-480.

| Módulo | Blanco RAL 9001 | Gris Metalizado |  |
|--------|-----------------|-----------------|---|
| 300    | 681.030.000     | 681.030.313     | 25  |
| 350    | 681.035.003     | 681.035.316     |   |
| 400    | 681.040.006     | 681.040.312     |   |
| 450    | 681.045.002     | 681.045.315     |   |
| 500    | 681.050.005     | 681.050.311     |   |
| 600    | 681.060.004     | 681.060.310     |   |

Se suministra en cajas de 25 unidades.



##### Cajón COMBI-480 KIT-4.

| Módulo | Blanco RAL 9001 | Gris Metalizado |  |
|--------|-----------------|-----------------|---|
| 300    | 681.130.004     | 681.130.310     | 1   |
| 350    | 681.135.000     | 681.135.313     |   |
| 400    | 681.140.003     | 681.140.316     |   |
| 450    | 681.145.006     | 681.145.312     |   |
| 500    | 681.150.002     | 681.150.315     |   |
| 600    | 681.160.001     | 681.160.314     |   |

Cada referencia se compone de 4 cajones con sus correspondientes correderas, enganches y tirafondos.



##### Cajón COMBI-480 KIT-5.

| Módulo | Blanco RAL 9001 | Gris Metalizado |  |
|--------|-----------------|-----------------|---|
| 300    | 681.230.001     | 681.230.314     | 1   |
| 350    | 681.235.004     | 681.235.310     |   |
| 400    | 681.240.000     | 681.240.313     |   |
| 450    | 681.245.003     | 681.245.316     |   |
| 500    | 681.250.006     | 681.250.312     |   |
| 600    | 681.260.005     | 681.260.311     |   |

Cada referencia se compone de 5 cajones con sus correspondientes correderas, enganches y tirafondos.



■ Correderas

Corredera costado 15÷16mm.

| Ps | Blanco RAL 9001 | Gris Metalizado |  |
|----|-----------------|-----------------|---|
| 90 | 788.316.001     | 788.316.314     | 100   |

Cada referencia se compone de un juego.

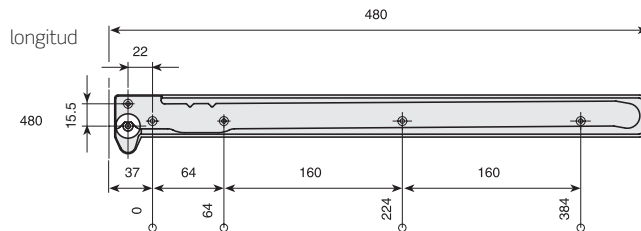
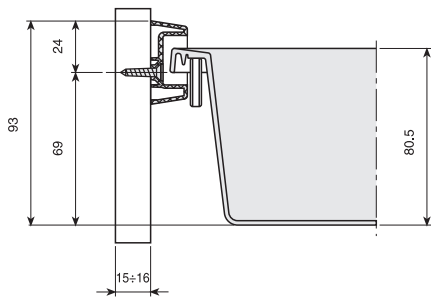

■ Enganche del frente

Enganche frontal regulable.

|  | Blanco RAL 9001 | Gris Metalizado |  |
|--|-----------------|-----------------|---|
|  | 685.000.002     | 685.000.315     | 100   |

Cada referencia se compone de un juego completo de enganches.

Enganche frontal regulable con aletas a 15mm.

|  | Blanco RAL 9001 | Gris Metalizado |  |
|--|-----------------|-----------------|---|
|  | 685.200.003     | 685.200.316     | 100   |

Cada referencia se compone de un juego completo de enganches.

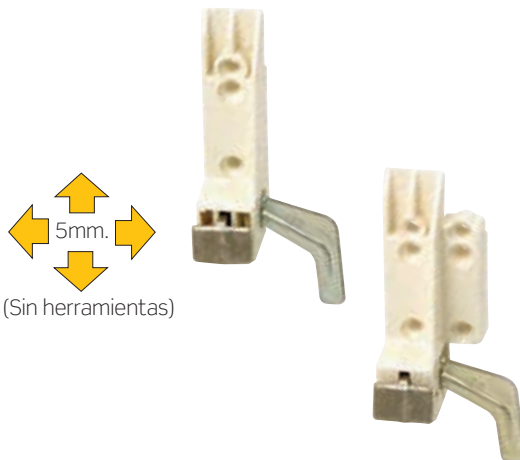

| Módulo | F   |
|--------|-----|
| 300    | 162 |
| 350    | 212 |
| 400    | 262 |
| 450    | 312 |
| 500    | 362 |
| 600    | 462 |

**NOTA**  
para la colocación del  
enganche con aletas hay que  
sumarle 30mm. a la cota F.

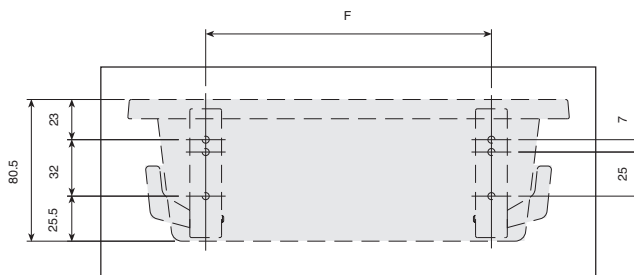

■ Accesorios cajón cacerolero

Cerco para cajón COMBI-480.

| Módulo | L   | Cromado     |    |
|--------|-----|-------------|----|
| 300    | 230 | 745.330.121 | 20 |
| 350    | 280 | 745.335.124 |    |
| 400    | 330 | 745.340.120 |    |
| 450    | 380 | 745.345.123 |    |
| 500    | 430 | 745.350.126 |    |
| 600    | 530 | 745.360.125 |    |

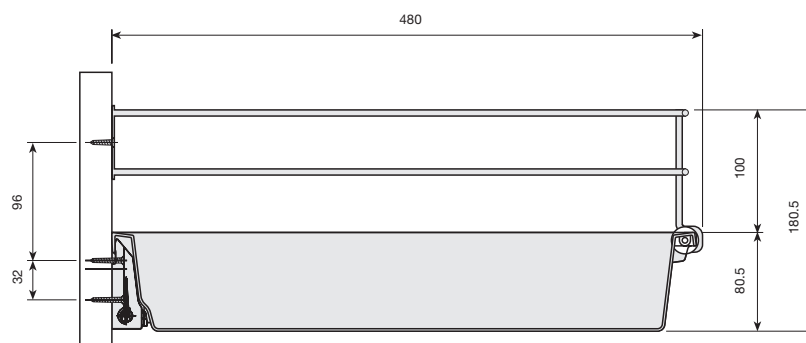
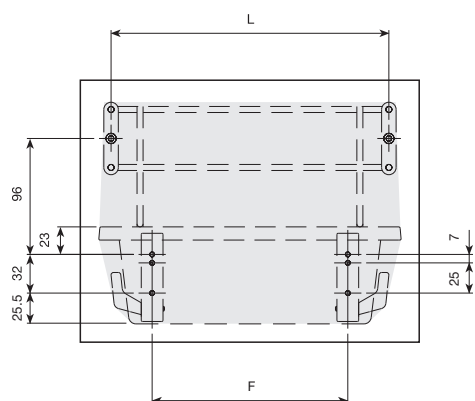
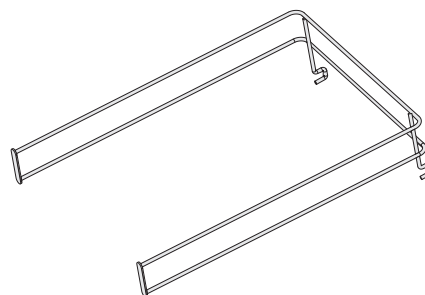

■ Cuberteros

Cuberteros diseñados para modulaciones del cajón COMBI. Este cubertero se presenta en dos versiones: ajustado en cuatro lados para todos los módulos, y con faldón lateral para cajones a partir de módulo 350 y 450, dando una mayor versatilidad, ya que sirve para varios modelos.

Cubertero COMBI-480.

| Módulo | Blanco RAL 9001 | Gris Metalizado |    |
|--------|-----------------|-----------------|----|
| 300*   | 687.930.003     | 687.930.316     | 20 |
| 350    | 687.635.001     | 687.635.314     |    |
| 400*   | 687.940.002     | 687.940.315     |    |
| 450    | 687.645.000     | 687.645.313     |    |
| 500    | 687.650.003     | 687.650.316     |    |
| 600    | 687.660.002     | 687.660.315     |    |

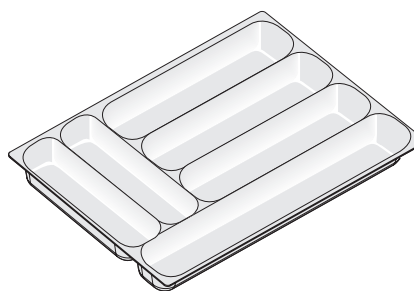

Cubertero COMBI-480 con aleta.

| Módulo | Blanco RAL 9001 | Gris Metalizado |    |
|--------|-----------------|-----------------|----|
| 350    | 687.935.006     | 687.935.312     | 25 |
| 450    | 687.945.005     | 687.945.311     |    |

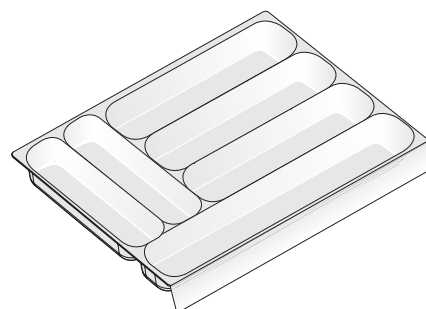

Estos cuberteros llevan faldón, y sirven para cajones a partir del módulo 350 y 450 respectivamente.



■ Accesorios: Esterilla antideslizante

Esterilla antideslizante para depositar en todos los cajones, especialmente caceroleros y evitar de esta manera el desplazamiento de los elementos de cocina y el rayado del fondo. Se puede cortar directamente del rollo a la medida del cajón.

Esterilla antideslizante.

|      |             |   |   |
|------|-------------|---|---|
|      |             |   |  |
| Gris | 443.050.300 | 1 |   |

Se suministra en rollos de 20mts. de longitud y 500mm. de ancho.

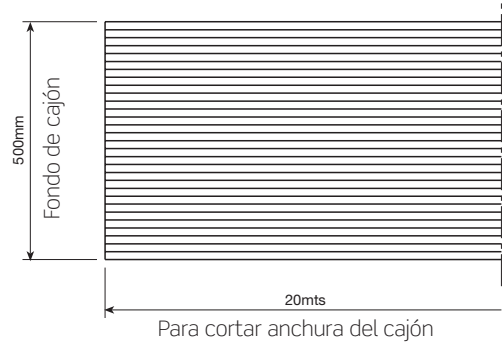

■ COMBI-480 INDAmatic

INDAmatic

Conjunto amortiguador + horquilla para COMBI-480.

|        |          |             |  |
|--------|----------|-------------|---|
| Blanco | RAL 9001 | 198.900.004 | 50  |
| Gris   | RAL 7040 | 198.900.310 |   |

Cada referencia se compone de 1 amortiguador y 1 horquilla.

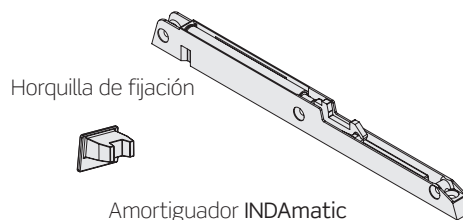

Cajón COMBI-480 con alojamiento INDAmatic.

| Módulo | Blanco RAL 9001 | Gris Metalizado |  |
|--------|-----------------|-----------------|---|
| 300    | 683.230.004     | 683.230.310     | 25  |
| 350    | 683.235.000     | 683.235.313     |   |
| 400    | 683.240.003     | 683.240.316     |   |
| 450    | 683.245.006     | 683.245.312     |   |
| 500    | 683.250.002     | 683.250.315     |   |
| 600    | 683.260.001     | 683.260.314     |   |

Se suministra en cajas de 25 unidades.



Cajón COMBI-480 con alojamiento INDAmatic. KIT-4.

| Módulo | Blanco RAL 9001 | Gris Metalizado |  |
|--------|-----------------|-----------------|---|
| 300    | 686.330.002     | 686.330.315     | 1   |
| 350    | 686.335.005     | 686.335.311     |   |
| 400    | 686.340.001     | 686.340.314     |   |
| 450    | 686.345.004     | 686.345.310     |   |
| 500    | 686.350.000     | 686.350.313     |   |
| 600    | 686.360.006     | 686.360.312     |   |

Cada referencia se compone de 4 cajones con sus correspondientes correderas, enganches, tirafondos y conjunto INDAmatic.



Cajón COMBI-480 con alojamiento INDAmatic. KIT-5.

| Módulo | Blanco RAL 9001 | Gris Metalizado |  |
|--------|-----------------|-----------------|---|
| 300    | 686.430.006     | 686.430.312     | 1   |
| 350    | 686.435.002     | 686.435.315     |   |
| 400    | 686.440.005     | 686.440.311     |   |
| 450    | 686.445.001     | 686.445.314     |   |
| 500    | 686.450.004     | 686.450.310     |   |
| 600    | 686.460.003     | 686.460.316     |   |

Cada referencia se compone de 5 cajones con sus correspondientes correderas, enganches, tirafondos y conjunto INDAmatic.



> Correderas

Corredera costado 15÷16mm.

| Ps | Blanco RAL 9001 | Gris Metalizado |  |
|----|-----------------|-----------------|---|
| 90 | 788.316.001     | 788.316.314     | 100   |

Cada referencia se compone de un juego.

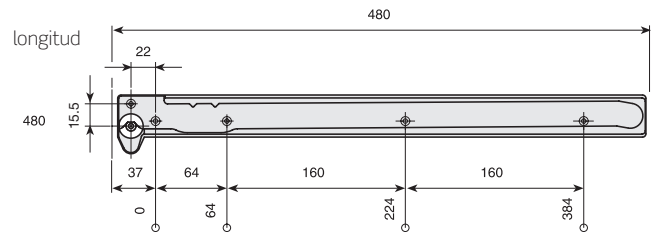
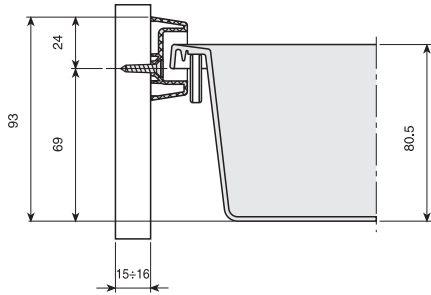

> Enganche del frente

Enganche frontal regulable.

|  | Blanco RAL 9001 | Gris Metalizado |  |
|--|-----------------|-----------------|---|
|  | 685.000.002     | 685.000.315     | 100   |

Cada referencia se compone de un juego completo de enganches.

Enganche frontal regulable con aletas a 15mm.

|  | Blanco RAL 9001 | Gris Metalizado |  |
|--|-----------------|-----------------|---|
|  | 685.200.003     | 685.200.316     | 100   |

Cada referencia se compone de un juego completo de enganches.

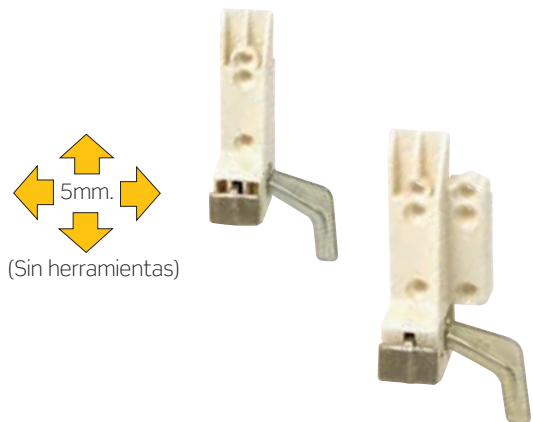

| Módulo | F   |
|--------|-----|
| 300    | 162 |
| 350    | 212 |
| 400    | 262 |
| 450    | 312 |
| 500    | 362 |
| 600    | 462 |

**NOTA**  
para la colocación del  
enganche con aletas hay que  
sumarle 30mm. a la cota F.

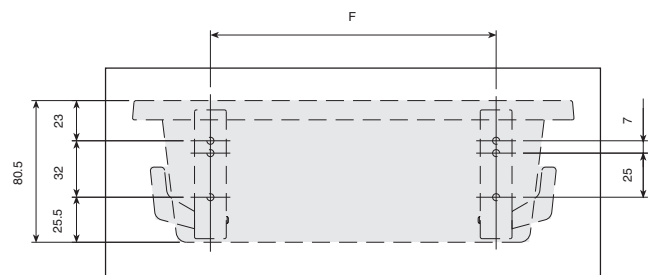

Montaje

Fijacion al costado

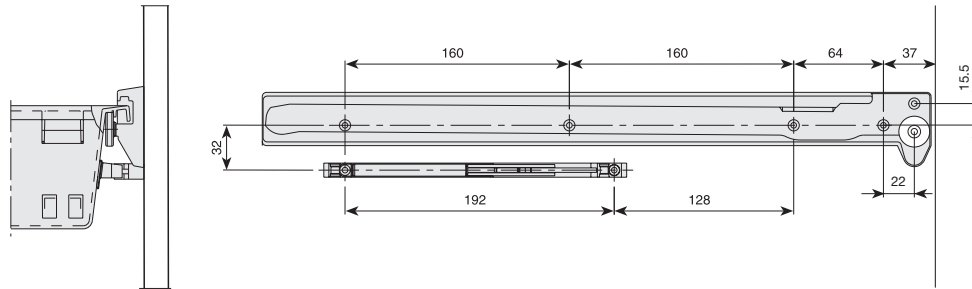

Montaje de la horquilla

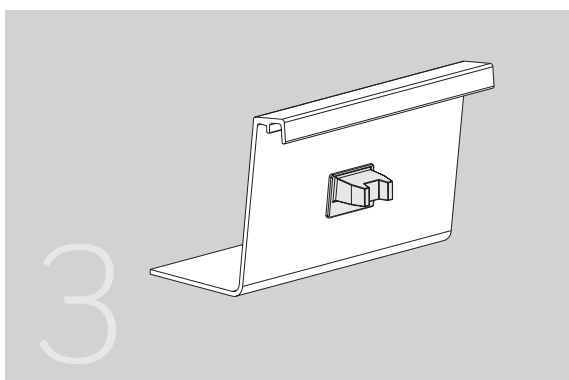
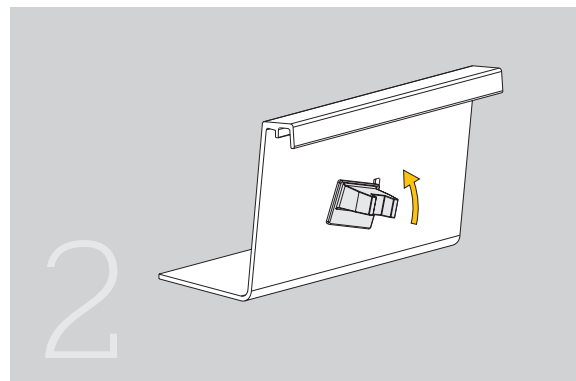
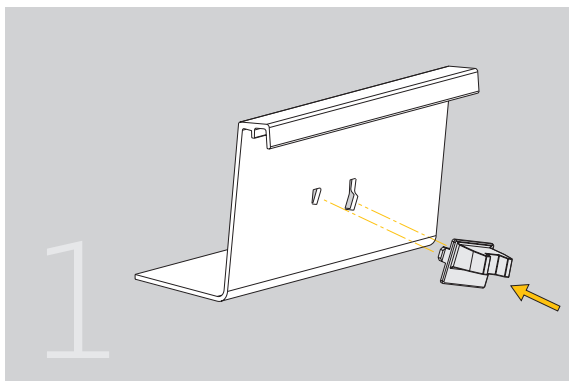

**NOTA**

El sistema de autocierre amortiguado INDAmatic va instalado en el lado derecho del cajón.