



# HERRAJES PARA PUERTAS PLEGABLES

Para armarios con puertas de aluminio y/o madera.

|                           |     |
|---------------------------|-----|
| <b>1</b> PLEGABLES .....  | 608 |
| ■ Perfiles y carros ..... | 608 |
| ■ Bisagras .....          | 609 |
| ■ Datos técnicos .....    | 610 |

**1 PLEGABLES**

■ Perfiles y carros

Perfil superior.

|                        | Cortado a medida | Barras de 2m. | Barras de 3m. | Barras de 6m. |  |
|------------------------|------------------|---------------|---------------|---------------|---|
| Anodizado color plata  | 710.900.105      | 710.920.103   | 710.930.102   | 710.960.106   | 10  |
| Natural (Sin anodizar) | 710.900.503      | 710.920.501   | 710.930.500   | 710.960.504   |   |

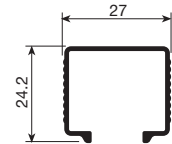

Carro superior.

| Para puerta de | Madera      | Aluminio    |  |
|----------------|-------------|-------------|---|
|                | 344.020.025 | 344.040.023 | 50  |

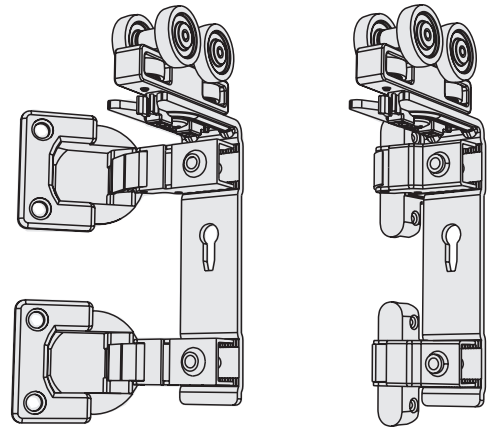
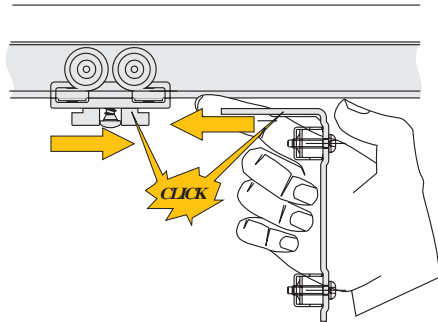

Perfil inferior.

|                        | Barras de 2m. |  |
|------------------------|---------------|---|
| Anodizado color plata  | 711.500.101   | 10  |
| Natural (Sin anodizar) | 711.500.506   |   |

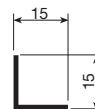

Carro inferior.

| Para puerta de | Madera      | Aluminio    |  |
|----------------|-------------|-------------|---|
|                | 343.706.064 | 344.406.064 | 50  |

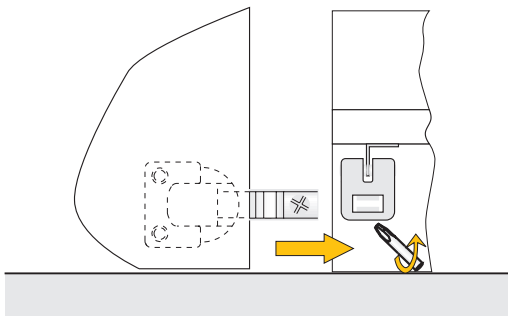
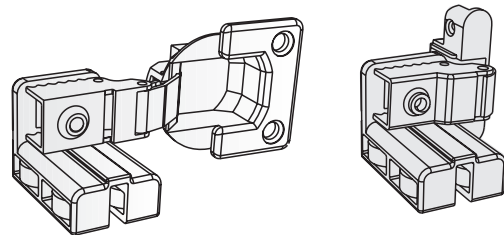

■ Bisagras

Bisagra intermedia aluminio-aluminio.

|           |             |   |
|-----------|-------------|---|
|           |             |  |
| Niquelado | 344.130.065 | 50  |

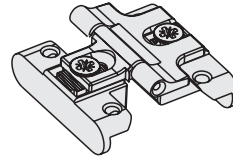

Bisagra intermedia madera-aluminio.

|           |             |   |
|-----------|-------------|---|
|           |             |  |
| Niquelado | 344.140.064 | 50  |

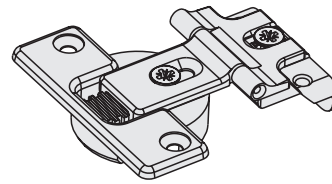

Bisagra intermedia aluminio-madera.

|           |             |   |
|-----------|-------------|---|
|           |             |  |
| Niquelado | 344.150.063 | 50  |

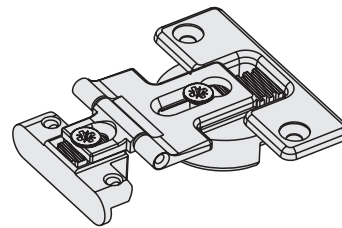

Bisagra intermedia madera-madera.

|           |             |   |
|-----------|-------------|---|
| Zamak     |             |  |
| Niquelado | 344.100.061 | 50  |

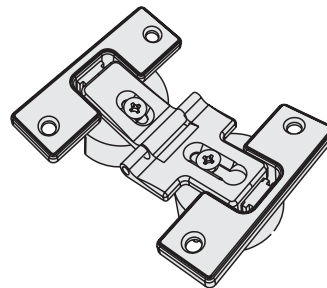

Bisagra intermedia madera-madera.

|                |             |   |
|----------------|-------------|---|
| Nylon          |             |  |
| Negro RAL 9005 | 344.110.023 | 150   |
| Gris RAL 7040  | 344.110.314 |   |

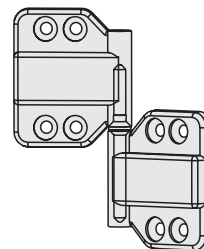

**DATOS TÉCNICOS**

Combinaciones de puertas:  
 Posibles combinaciones de puertas en aluminio y madera.  
 Nos servirá para ver la elección de la bisagra intermedia.

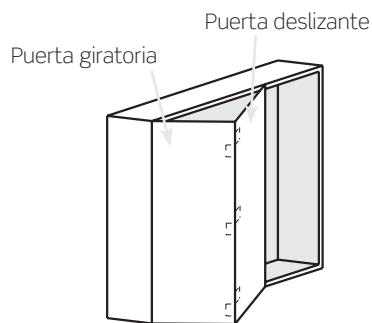

*Aluminio - aluminio*

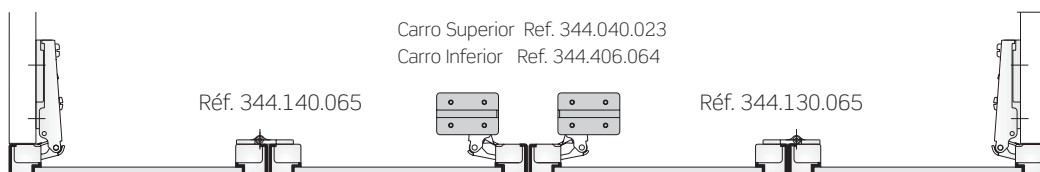

*Madera - aluminio*

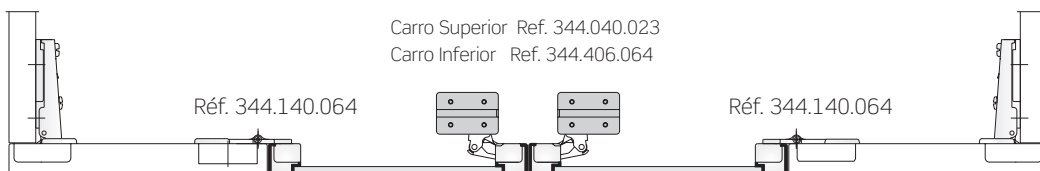

*Aluminio - madera*

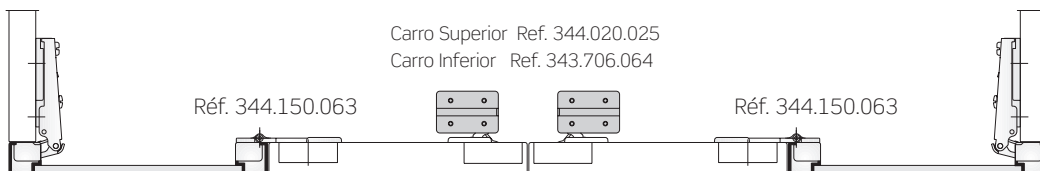

*Madera - madera (bisagra de ZAMAK)*

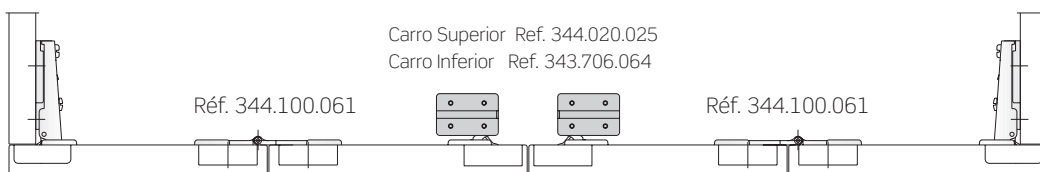

*Madera - madera (bisagra de NYLON)*

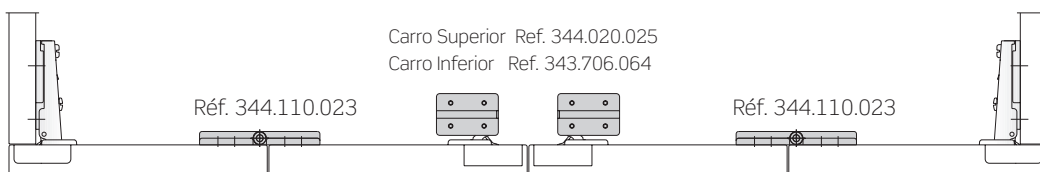

**DATOS TÉCNICOS**

*Alojamiento de los herrajes*

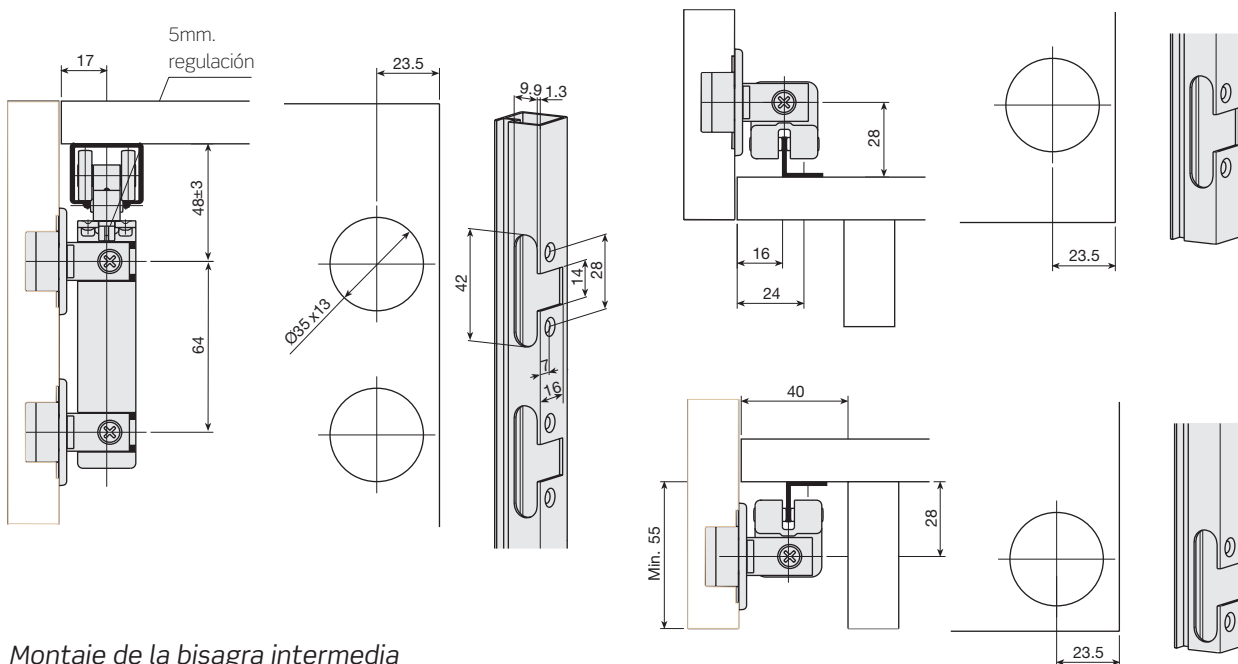

*Montaje de la bisagra intermedia*

Bisagras de ZAMAK

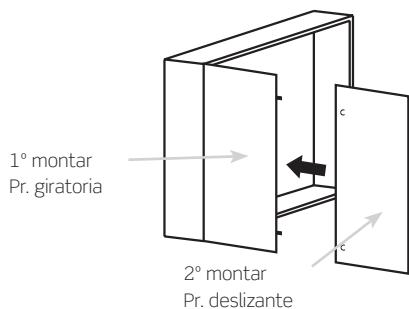

Bisagra en NYLON

Las bisagras de la puerta deslizable se colocan por encima de las de la puerta giratoria.

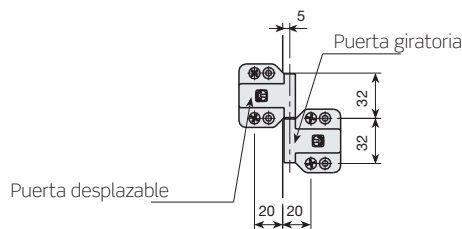

Vista desde el interior del armario

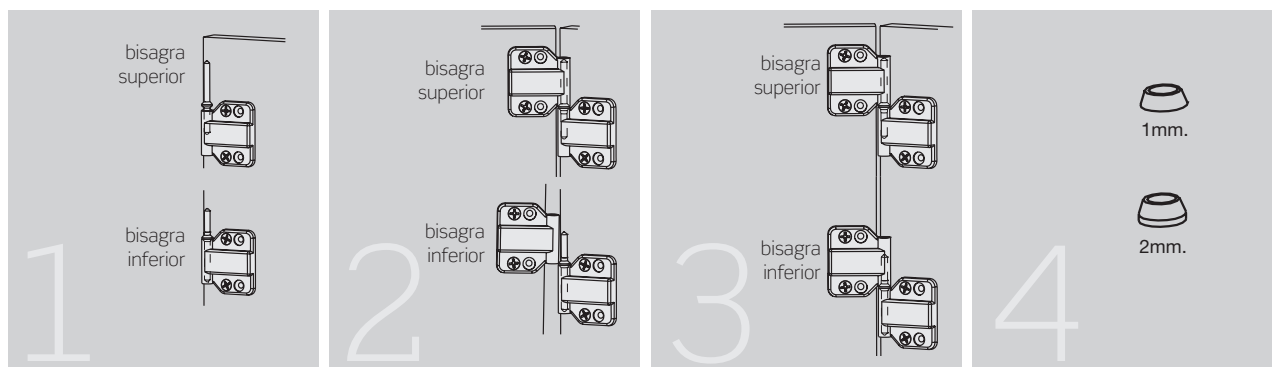

**Colocar los ejes:**  
 Introducir la parte más corta del eje en la bisagra superior.  
 Introducir la parte más larga del eje en la bisagra inferior.

**Colocar la puerta deslizable:**  
 Introducir únicamente la bisagra superior.

**Alinear ambas puertas:** Guiando en el eje de la bisagra superior, levantar la puerta hasta alinear las bisagras inferiores con sus ejes. Al descender la puerta se encajará automáticamente.

**Para posibles regulaciones:**  
 Utilizar las arandelas incluidas con las bisagras.